



Orchard Close, Denham, Uxbridge, UB9 4BB

- Detached chalet bungalow
- No onward chain
- Gated private road
- Primary bedroom with en-suite
- Contemporary design throughout
- Three double bedrooms
- Open plan living space
- Luxurious family bathroom
- Front and rear gardens
- Deceptively spacious accommodation

Asking Price £650,000

Cameron Estate Agents
195 High Street,
Middlesex, Uxbridge, UB8 1LB

E: uxbridge@cameron.co
T: 01895252000

www.cameron.co



Description

A beautifully presented three-bedroom detached chalet bungalow, showcasing contemporary design throughout. Featuring an impressive open-plan living space with a modern fitted kitchen and bi-fold doors opening onto a secluded low-maintenance rear garden, the property is ideal for modern family living and entertaining. Further benefits include a luxurious four-piece bathroom, en suite to the principal bedroom, flexible ground-floor accommodation suitable for a home office or additional reception room, and off-street parking for up to three vehicles.

Accommodation

The accommodation is thoughtfully arranged and briefly comprises a welcoming entrance hall leading through to an impressive open-plan living space, seamlessly incorporating a contemporary fitted kitchen. Bi-fold doors flood the room with natural light and open directly onto the secluded low maintenance rear garden, creating an effortless transition between indoor and outdoor living—ideal for both entertaining and everyday family life.

The ground floor also benefits from a versatile third bedroom, which could equally serve as an additional reception room, guest bedroom or home office. Completing the ground floor is a luxurious four-piece family bathroom.

To the first floor are two spacious double bedrooms, including an impressive primary bedroom enjoying the added luxury of a walk in wardrobe and stylish en-suite shower room.

Outside

To the rear, there is a secluded, low-maintenance garden, complete with a timber garden shed.

At the front there is an enclosed garden area that is predominantly laid to lawn with a paved pathway leading to the property.

A hardstanding driveway to the front provides off-street parking for up to three vehicles.

Situation

Orchard Close is an exclusive, gated private road positioned just off Newtown Road, ideally located within easy reach of Uxbridge Town Centre, which offers an excellent selection of highly regarded restaurants, cafés and bars, as well as the popular Intu Uxbridge and The Pavillions shopping centres. Uxbridge Underground Station, served by the Metropolitan and Piccadilly lines, along with Uxbridge Bus Station, is conveniently situated in the heart of the town centre, providing excellent transport links into London and beyond.

The area also benefits from an outstanding range of leisure and sporting facilities, including Hillingdon Golf and Cricket Club, Court Park with its tennis courts and bowls club, and the Uxbridge Sports and Leisure Complex, home to an Olympic-sized outdoor swimming pool.

Further enhancing the location's appeal, Heathrow Airport, Stockley Park, Hillingdon Hospital and Brunel University are all easily accessible, while the A40, M40 and M25 provide excellent road connections for commuters and travellers alike.

Terms and notification of sale

Tenure: Freehold

Local Authority: South Bucks District Council

Council Tax Band: E

Current EPC Rating: C

IMPORTANT NOTICE

These particulars have been prepared upon information supplied by the Vendor and should be verified by your surveyors and solicitors. In accordance with the Property Misdescriptions Act 1991 we have prepared these sales particulars as a general guide to give a broad description of the property. They are not intended to constitute part of an offer or contract. We have not carried out a structural survey and the services, appliances and specific fittings have not been tested. All photographs, measurements, floor plans and distances referred to are given as a guide only and should not be relied upon for the purchase of carpets or any other fixtures or fittings. Lease details service charge and ground rent (where applicable) are given as a guide only and should be checked and confirmed by your solicitor prior to exchange of contract



GROUND FLOOR
APPROX. FLOOR
AREA 687 SQ.FT.
(63.8 SQ.M.)

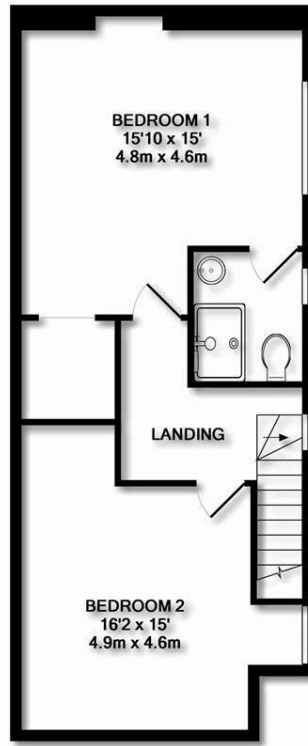

1ST FLOOR
APPROX. FLOOR
AREA 544 SQ.FT.
(50.6 SQ.M.)

TOTAL APPROX. FLOOR AREA 1231 SQ.FT. (114.4 SQ.M.)

Whilst every attempt has been made to ensure the accuracy of the floor plan contained here, measurements of doors, windows, rooms and any other items are approximate and no responsibility is taken for any error, omission, or mis-statement. This plan is for illustrative purposes only and should be used as such by any prospective purchaser. The services, systems and appliances shown have not been tested and no guarantee as to their operability or efficiency can be given

Made with Metropix ©2016

Cameron

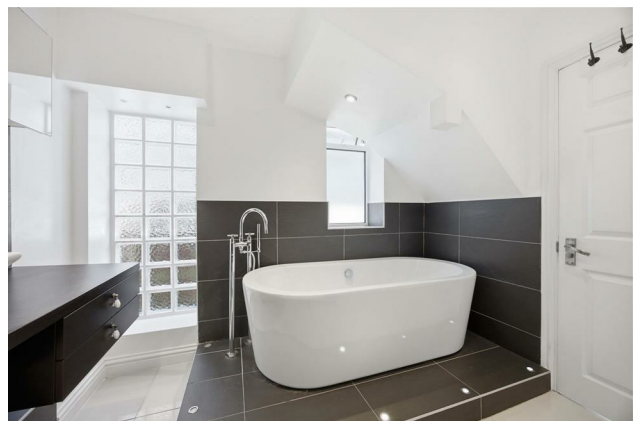

Whilst every care has been taken to ensure the accuracy of these particulars, none of the statements contained herein are to be relied upon as representations of fact. These particulars do not constitute an offer or contract.